

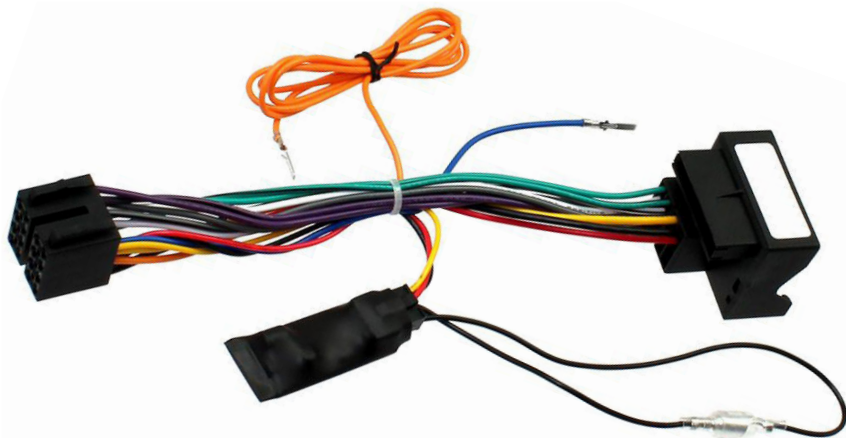

Designed and  
Engineered  
in the UK. 

## CTHUE-CT1 12V Ignition CAN-Bus solution for Citroen



**CAN-Connect is the leading CAN-Bus integration solutions for the automotive industry.**



CAN-Connect ist die führende CAN-Bus-Integrationslösung für die Automobilindustrie.



CAN-Connect son las soluciones de integración CAN-Bus líderes en la industria del automóvil.



CAN-Connect est le leader des solutions d'intégration Can-bus de l'industrie automobile.



CAN-Connect è la principale soluzione di integrazione CAN-BUS nel settore automobilistico.

### Technical Support?

for technical support please use our  
dedicated system [support.connects2.com](http://support.connects2.com)

**Connects2.com**



...connecting to the aftermarket

### DISCLAIMER

The information provided in this document is subject to change without notice due to manufacturer changes and/or improvements to the product/s. This instruction manual is based on documented data and research. The manufacturer of this product cannot be held responsible for any changes made to the vehicle by the manufacturer or damages that may occur through the installation of this product in accordance with the steps outlined herein.

# Features

---

- Plug & play solution - head unit replacement made easy
- Generates 12V Ignition feed
- Includes simple programming connection for quick learning process

This particular product supports the following outputs:



# Wire Colours

---

|                           |   |
|---------------------------|---|
| <b>Speed Pulse</b>        | <b>Pink / Rosa / Rosado / Rose / Rosa</b>           |
| <b>Illumination</b>       | <b>Orange / Orange / Naranja / Orange / Arancia</b> |
| <b>Ignition 12V</b>       | <b>Red / Rot / Rojo / Rouge / Rosso</b>             |
| <b>Amp/Antenna Remote</b> | <b>Blue / Blau / Azul / Bleu / Blu</b>              |

# Product Details

---

| <u>Manufacturer</u> | <u>Model</u> | <u>Year(s)</u> | <u>Connector</u> |
|---------------------|--------------|----------------|------------------|
| Citroen             | Berlingo     | 2008 >         | Quadlock (Fakra) |
| Citroen             | C2           | 2005 >         | Quadlock (Fakra) |
| Citroen             | C3           | 2005 - 2016    | Quadlock (Fakra) |
| Citroen             | C3-Picasso   | 2009 >         | Quadlock (Fakra) |
| Citroen             | C4           | 2004 >         | Quadlock (Fakra) |
| Citroen             | C4-Picasso   | 2006 >         | Quadlock (Fakra) |
| Citroen             | C5           | 2005 >         | Quadlock (Fakra) |
| Citroen             | C6           | 2005 >         | Quadlock (Fakra) |
| Citroen             | C8           | 2005 >         | Quadlock (Fakra) |
| Citroen             | DS3          | 2009 >         | Quadlock (Fakra) |
| Citroen             | DS4          | 2010 >         | Quadlock (Fakra) |
| Citroen             | DS5          | 2011 >         | Quadlock (Fakra) |

# Programming Wire

---

Each IGNI interface comes with a programming wire.  
This wire is used to configure the 12V Ignition feed for your new head unit.  
This should not be connected to anything other than itself.



# Installation

---

## Step 1.

Remove OEM head unit following manufacturers instruction.

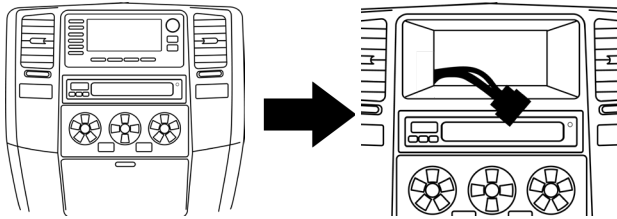

## Step 2.

Connect vehicle specific connector to OEM harness. Connect ISO connector to aftermarket head unit.

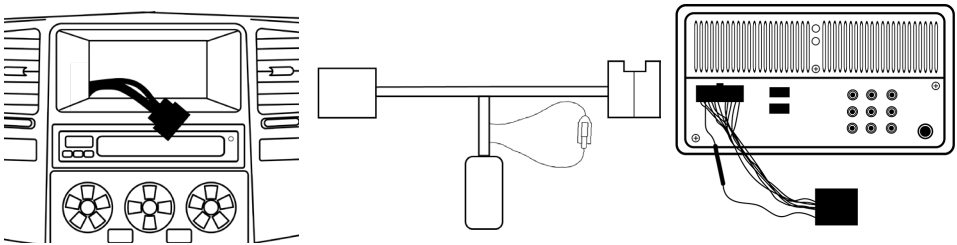

\*Connect required analogue flying wires to aftermarket head unit using colour table.

---

## Step 3.

When connected correctly, start the engine. Disconnect the '**programming wire**'. Wait roughly 5 seconds and re-connect the wire. This will start the learning process - the 12V Ignition feature will activate during this time.

Wait 1 minute, then turn engine off. The ignition output should turn off after 40 seconds.

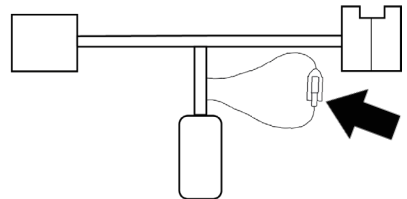

## Step 4.

When connected appropriately and tested, re-assemble dashboard with aftermarket head unit.

